

Technical Datasheet

Product Code: **CM340615000**

Product Description: **CARRARA & MATTA ProSeat Sta-Tite Silentium Smart L**

Specification

Seat Type:	Soft Close
Barcode:	8000367009113
Packaged Weight (kg):	3.197 kg



Key Features

- Your seat stays tight with STA-TITE® fixing system
- Silentium® soft close
- Smart Lift™ take off for easy cleaning
- Quality moulded wood with high-gloss finish
- Fixed center chrome-plated hinges
- Universal fit

Technical Drawing

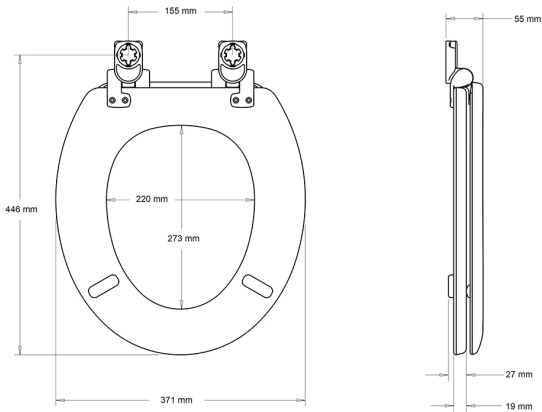

Dimensions: All measurements are in millimetres and are subject to normal manufacturing variations.

Due to a continuing development programme to improve design and performance, we reserve all rights to vary specifications without prior notice. Please note, all accessories are for photographic purposes only.