

# Technical Datasheet

Product Code: **GB.500.237.01.1**

Product Description: **Geberit Smyle Soft Close Slim Seat Wrap Over**

## Specification

Material:	Duroplast
Seat Type:	Soft Close
Product Guarantee:	2 Years
Barcode:	4025416520443
Packaged Weight (kg):	3.21 kg



## Key Features

- Smyle
- Soft Close
- Slim Seat
- Wrap Over

## Technical Drawing

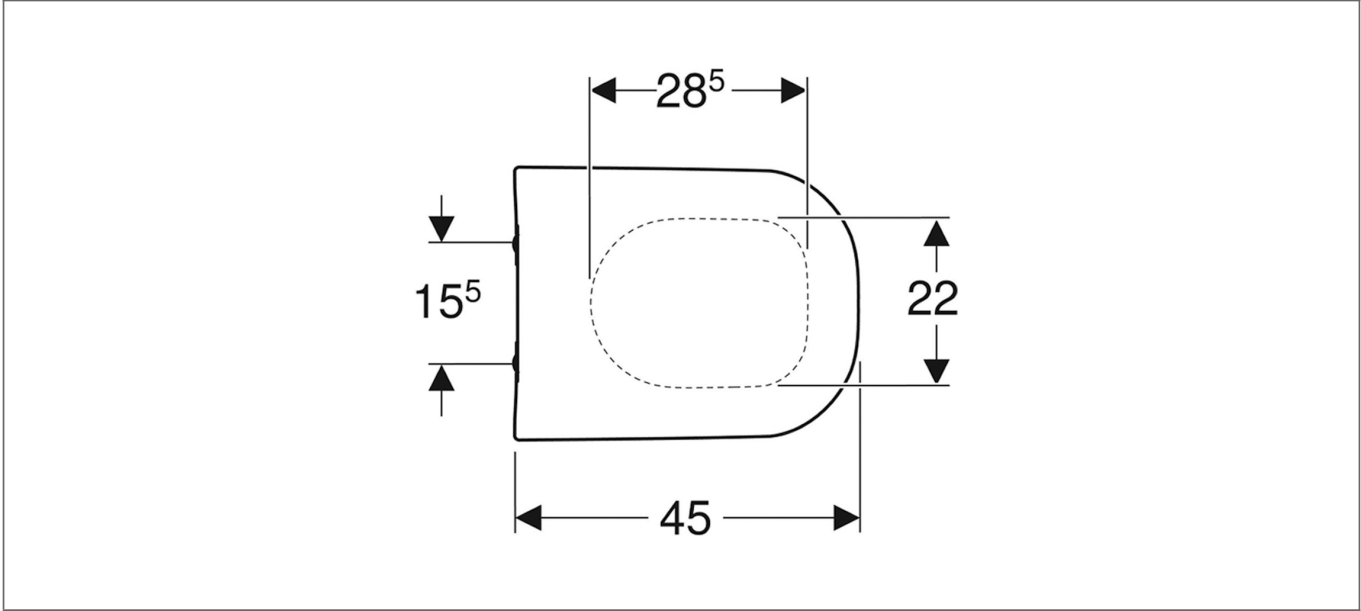

Dimensions: All measurements are in millimetres and are subject to normal manufacturing variations.  
Due to a continuing development programme to improve design and performance, we reserve all rights to vary specifications without prior notice. Please note, all accessories are for photographic purposes only.