

Technical Datasheet

Product Code: **GB.501.265.00.1**

Product Description: **Geb 501.265.00.1 Selnova Mirror Cabinet 2 Door**

Specification

Number Of Doors:	2
Number Of Shelves:	4
Handle Type:	Pull
Material:	Chipboard
Style:	Modern
Product Guarantee:	2 Years
Barcode:	4025410742025
Packaged Weight:	23 kg
Packaged Length (Metre):	0.635
Packaged Width (Metre):	0.215
Packaged Height (Metre):	0.89



Key Features

- Wide-ranging bathroom furniture collection with modern expressive design
- Manufactured from quality materials
- Features soft close doors for added safety measure
- Includes 4 adjustable shelves for added storage space
- Matching furniture is also available to purchase from the Selnova Square range

Technical Drawing

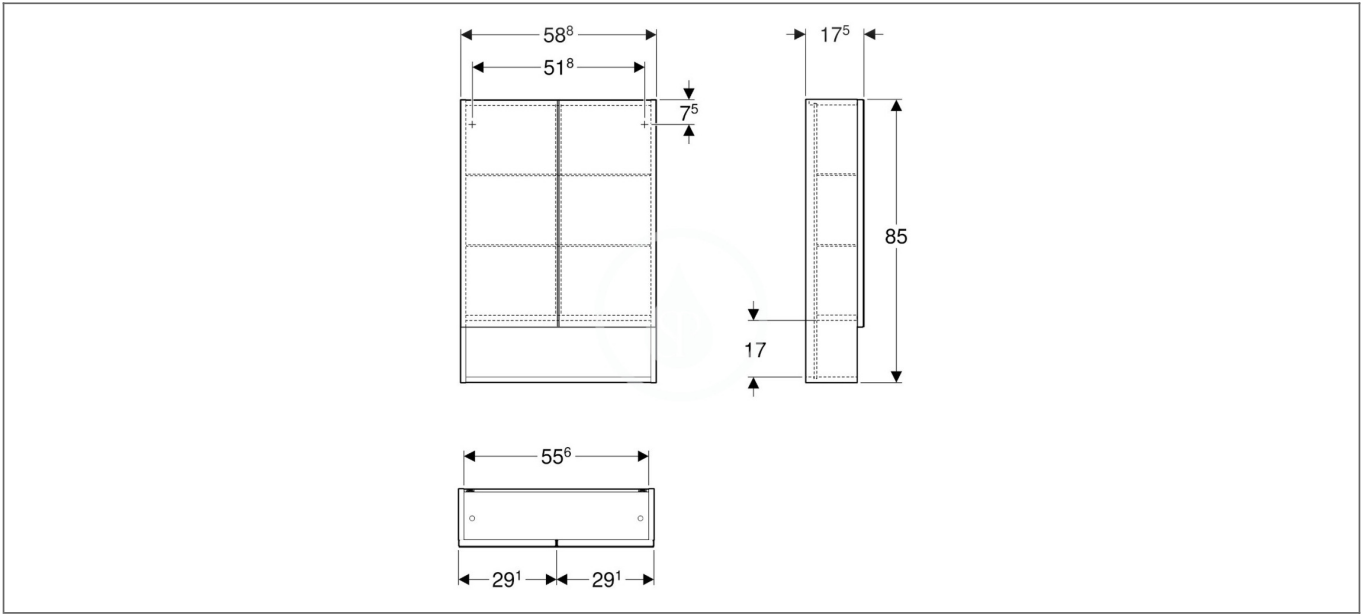

Dimensions: All measurements are in millimetres and are subject to normal manufacturing variations.

Due to a continuing development programme to improve design and performance, we reserve all rights to vary specifications without prior notice. Please note, all accessories are for photographic purposes only.