

Technical Datasheet

Product Code: **SUMCIST**

Product Description: **RAK Summit CC Dual Flush Cistern**

Specification

Product Guarantee:	25 Years
Barcode:	5056176002954
Packaged Weight (kg):	11.5 kg
Material:	Vitreous China
Style:	Modern
Flush Type:	Push Button
Cistern Flush:	Dual Flush



Key Features

- Wide-ranging bathroom collection with modern expressive design
- The natural raw materials make ceramic hard wearing, scratch-proof & resistant to limescale
- Designed for installation with close coupled pan
- Features dual flush function for less water consumption
- Matching sanitaryware is also available in the Summit range

Technical Drawing

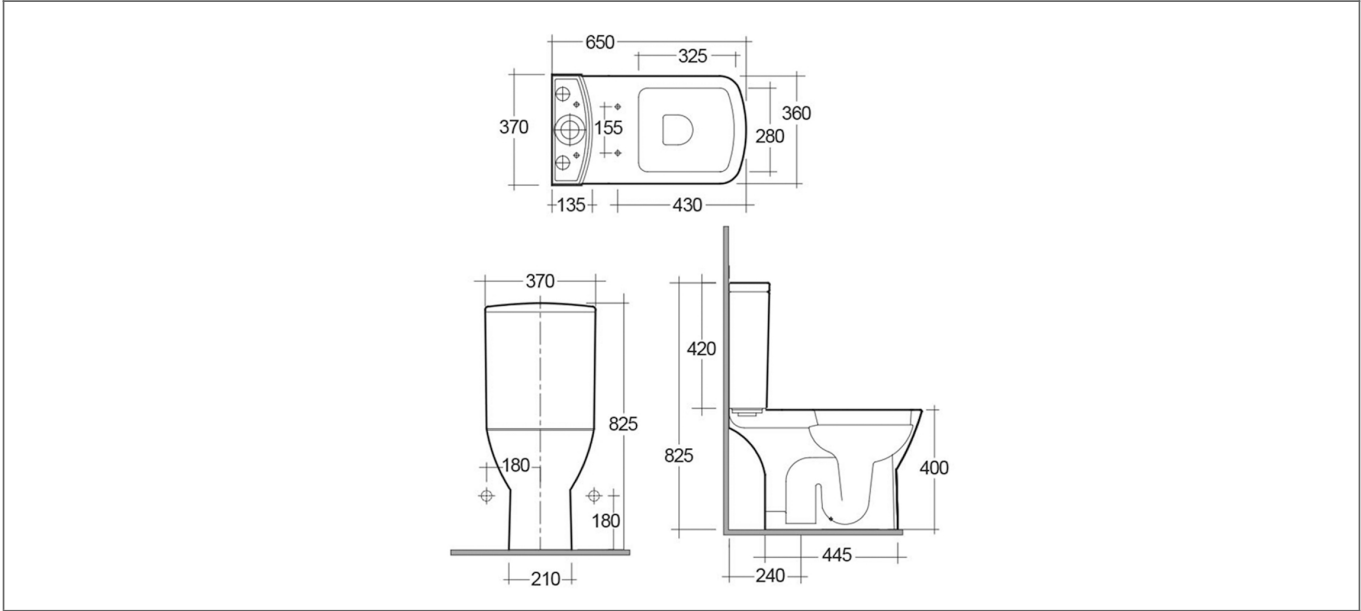

Dimensions: All measurements are in millimetres and are subject to normal manufacturing variations.

Due to a continuing development programme to improve design and performance, we reserve all rights to vary specifications without prior notice. Please note, all accessories are for photographic purposes only.