

Technical Datasheet

Product Code: **SY-CVQ04CR**



Product Description: **Synergy Concealed Twin Shower Valve CP**

Specification

Product Guarantee:	Lifetime
Material:	Brass
Handle Type:	Knob
Tap Pressure:	Low - High Pressure
Min Operating Pressure:	0.1 Bar
Approvals:	WRAS Approved
Projection (mm):	131.5
Flow Rate 0.1 Bar (L/min):	5.2
Flow Rate 0.5 Bar (L/min):	10
Flow Rate 1 Bar (L/min):	14
Flow Rate 2 Bar (L/min):	17.1
Flow Rate 3 Bar (L/min):	24
Flow Rate 4 Bar (L/min):	27.9
Flow Rate 5 Bar (L/min):	31
Colour:	Chrome

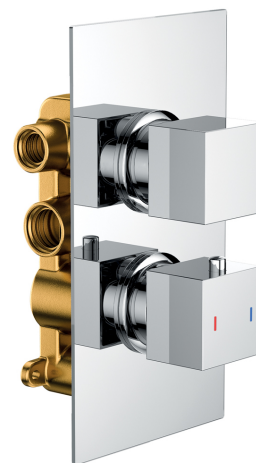

Key Features

- Create an aesthetic that is part of the constantly evolving contemporary style of present day
- Thermostatic valve helps maintain temperature control
- Features a automatic shut off valve for water supply failure
- Interchangeable design for horizontal & vertical installation
- Temperature: Pre-set 38°C, with push button override to 48°C

Technical Drawing

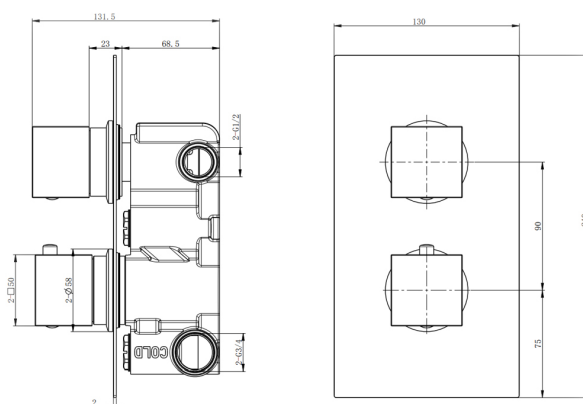

Dimensions: All measurements are in millimetres and are subject to normal manufacturing variations.

Due to a continuing development programme to improve design and performance, we reserve all rights to vary specifications without prior notice. Please note, all accessories are for photographic purposes only.