

Technical Datasheet

Product Code: **SY-G03**



Product Description: **Synergy Tec Studio G03 Bath Filler BPO**

Specification

Product Guarantee:	Lifetime
Barcode:	5056474512483
Material:	Brass
Handle Type:	Lever
Tap Pressure:	Low - High Pressure
Min Operating Pressure:	0.2 Bar
Waste Included:	No
Number Of Tap Holes:	2
Projection (mm):	118
Colour:	Chrome



Key Features

- Wide-ranging bathroom brassware collection with modern expressive design
- Manufactured from high quality brass
- Coated in a luxury chrome finish
- Features lever control for a flawless level flow
- Optional black & brushed brass finishes are also available

Technical Drawing

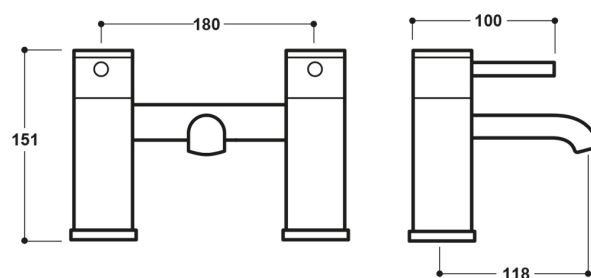

Dimensions: All measurements are in millimetres and are subject to normal manufacturing variations.

Due to a continuing development programme to improve design and performance, we reserve all rights to vary specifications without prior notice. Please note, all accessories are for photographic purposes only.